

Hillside Gardens Park

Landscape Design Sketchbook

March 2019



1. THE EXISTING PARK

THE EXISTING PARK















AREAS TO RETAIN & ENHANCE

1. Tennis Courts - Possible consolidation to locate together, new surfacing, new toilet block with possible meeting space and refreshments
2. Multi Use Games Area (MUGA) - Good provision, possible relocation to western edge. Would benefit from new surfacing and possible 5-a-side football pitch
3. Nursery ensure park is well used on a daily basis. Would benefit from a more harmonious boundary treatment and gathering space in centre of park.
4. Playground - Well equipped playground for younger children aged 5-12. Limited facilities for older children / young adults,

AREAS REQUIRING IMPROVEMENT

1. Poorly defined entrances. Particularly the primary entrance from Hillside Road, Would benefit from improved signage, opening views into park and a more attractive entrance.
2. No circular walking route. A large areas of the open space within the park is fenced with no access for dog walkers etc. A smaller fenced picnic area could open up the park and provide a circular route.
3. Limited facilities for young adults. Existing modest fitness area could be expanded to include cross fit equipment, climbing, table tennis or skating area.
4. Hard edges defined by back garden fences / walls on the east and west boundary and train line on the south edge. Ecologically rich hedge or flowering shrub planting could improve green character of park and enhance ecology and biodiversity.
5. Existing fencing and furniture in poor state of repair and required replacement with a robust and attractive palette of furniture.

KEY

	Tennis courts		Toilet block
	Multi-Use Games Area (MUGA)		Main entrance
	Nursery		Secondary entrances
	Community gardens / Allotments		Main routes
	Play area		Secondary paths
	Fitness/gym zone		
	Ornamental gardens		









DESIGN OPPORTUNITIES

The following improvement opportunities have been identified:

- 1 Relocate two tennis courts to create a bank of four tennis courts close to the refurbished toilet block. A refreshments kiosk could be opened during summer months to provide a revenue source within the park.
- 2 Relocate two MUGAs to the west boundary of the park. Possible extension to the north to create a new youth area with fitness or parkour equipment.
- 3 Improve the entrance and arrival space from Hillside Road. Sight lines and signage will be improved to mark the entrance and new seating and planting will create an attractive focal point.
- 4 Planting along the central avenue could be improved to enhance the green character of the park. New flowering tree planting would provide a striking feature and frame long range views.
- 5 Opportunity to create a well defined circular walking route within the park.
- 6 Opportunity for new hub space outside nursery with new seating enjoying south and east facing views.
- 7 Opportunity to improve and expand the existing play / fitness space, for young adults, possibly including Cross-fit, climbing wall or skating area, making better use of the large area of tarmac.
- 8 Opportunity to introduce a continuous planted edge to the park, softening edges defined by tall fences and walls and improving the parks ecological and habitat value.



KEY

	Consolidated tennis courts		Consolidated MUGA with improvements to surfacing and 5-a-side football pitch
	New toilet block with possible refreshment kiosk linked to tennis courts		New circular walking route
	Possible fitness / gym zone		Possible hub seating space linked to nursery
	Improved entrance area		Continuous planted edge
	Improved planting along central avenue		



2. OPPORTUNITIES

1. IMPROVED TENNIS COURTS



Brockwell Park Tennis Courts



Clapham Common Tennis Courts



Victoria Park Tennis Courts

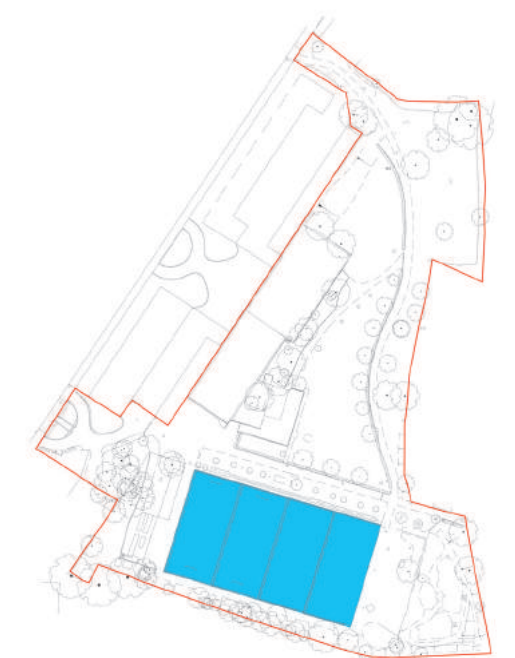

2. MULTI - USE GAMES AREA

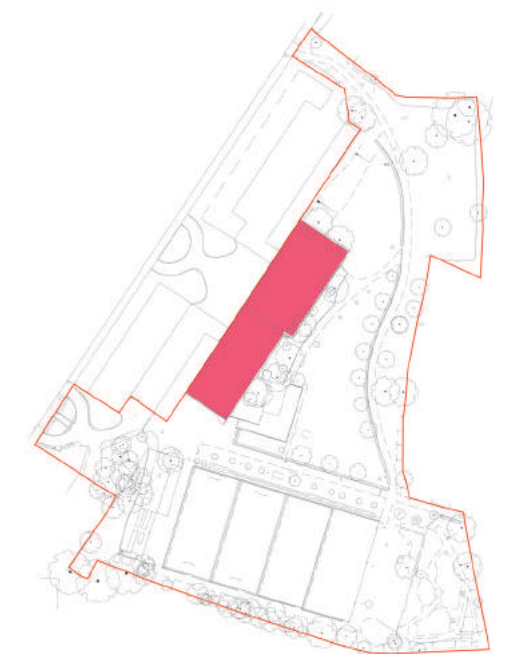

3. HILLSIDE ROAD ENTRANCE

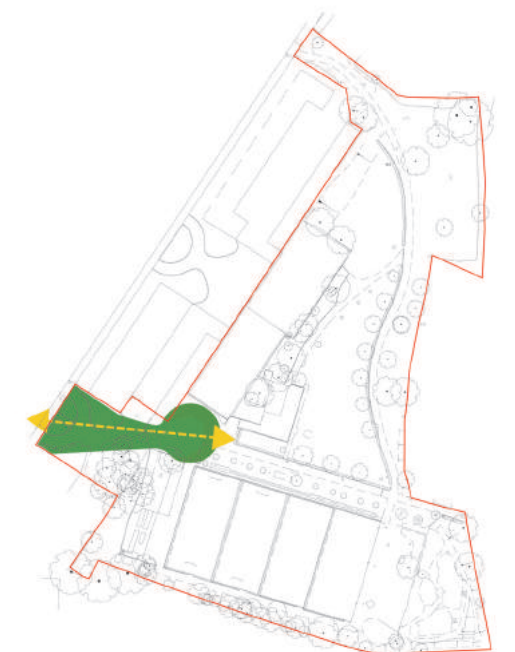

3. HILLSIDE ROAD ENTRANCE

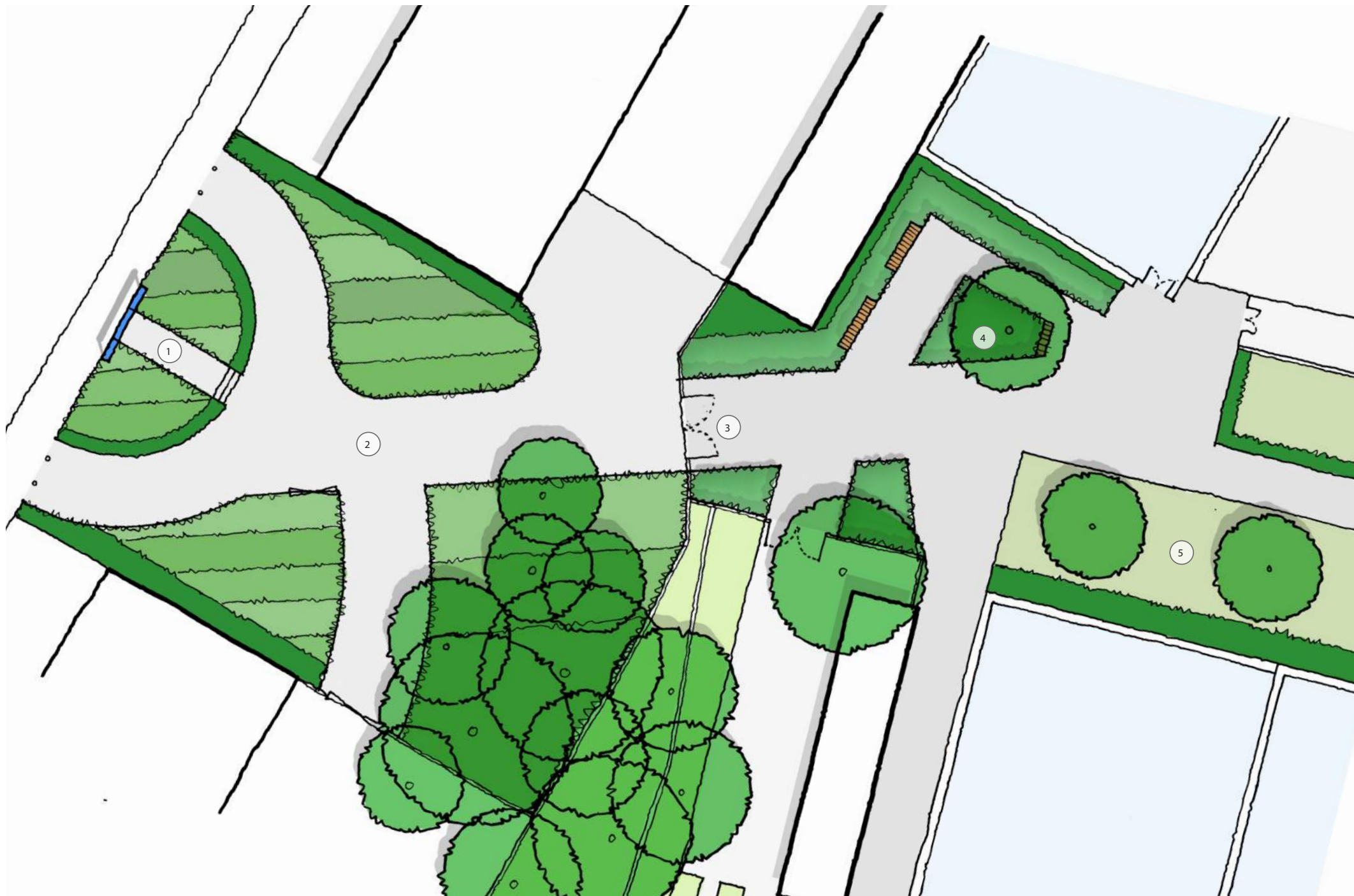

KEY

- ① New signage / entrance feature to park. Tall hedging replaced with lower ornamental planting encouraging views into the park from Hillside Road.
- ② Footpath and fencing realigned, with new low level planting to frame views into site from Hillside Road.
- ③ Gate realigned and widened to allow free pedestrian movement into park
- ④ Densely planted edge to boundary wall and fencing, new seating and a signature tree marking the primary site entrance.
- ⑤ New shrub and flowering avenue tree planting along central avenue frame views and creates attractive garden character to primary route within the park.

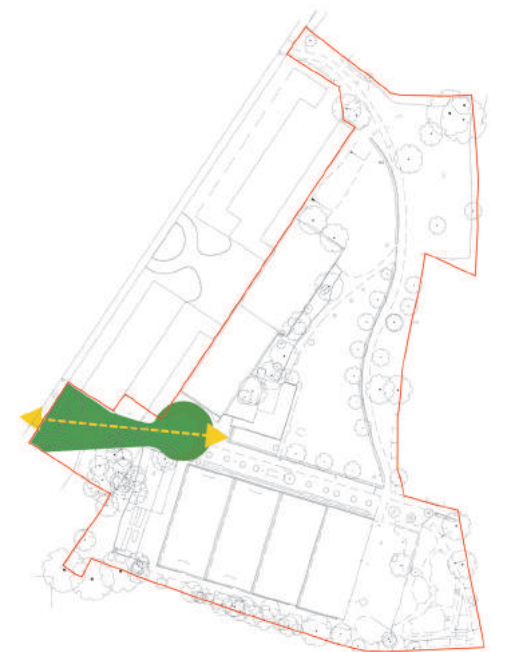

4. CIRCULAR ROUTE / IMPROVED PLANTING

Limited seating opportunities adjacent to nursery

Large area of park is fenced off with no access for dog walkers, preventing a circular walking route

No seating along primary route



Boundary with back gardens consists of exposed fencing with limited planting

Large area of park is fenced off with no access for dog walkers, preventing a circular walking route

Underused area of the park, possible location for youth activity adjacent to proposed MUGA



KEY



New seating area link to nursery with S-E views



Fences removed from main park area to create circular routes



Proposed fence and hedge boundary to picnic area



New planting to park edge

4. CIRCULAR ROUTE / IMPROVED PLANTING



KEY

- ① Picnic area secured by fencing and hedge. New gathering space adjacent of nursery with seating enjoying S-E views
- ② Fencing removed within the main body of the park, additional footpath to create circular routes.
- ③ New area with fitness or climbing equipment aimed at young adults, linked to relocated MUGA / football pitch.
- ④ New planted edge to park boundary, consisting of native hedge edge with ornamental species improving the green character of the park and enhancing biodiversity.



SKETCH OPTIONS

EXTENDED PLAY AREA / YOUTH SPACE



KEY

- 1 Existing play area to be retained
- 2 Existing outdoor gym to be retained
- 3 Proposed climbing wall or bouldering structure
- 4 Existing table tennis zone extended
- 5 Extended table tennis area
- 6 New skating area for skateboards and scooters
- 7 Improved entrance with new paving and seating.

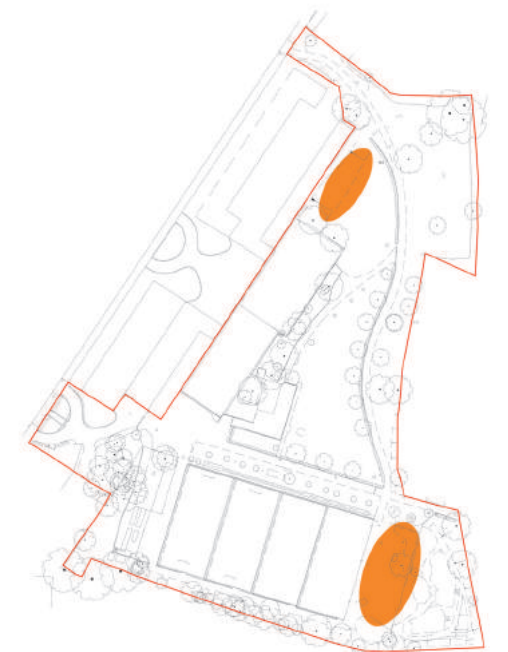

SKETCH OPTIONS

EXTENDED PLAY AREA / YOUTH SPACE



QE Olympic Park Climbing Walls



Peckham Rye Park Skating Area



Cross Fit Equipment



Normand Park Climbing Wall



Colourful table tennis